

SycoTec Fan set 2.001.7298

Assembly Instructions

EN

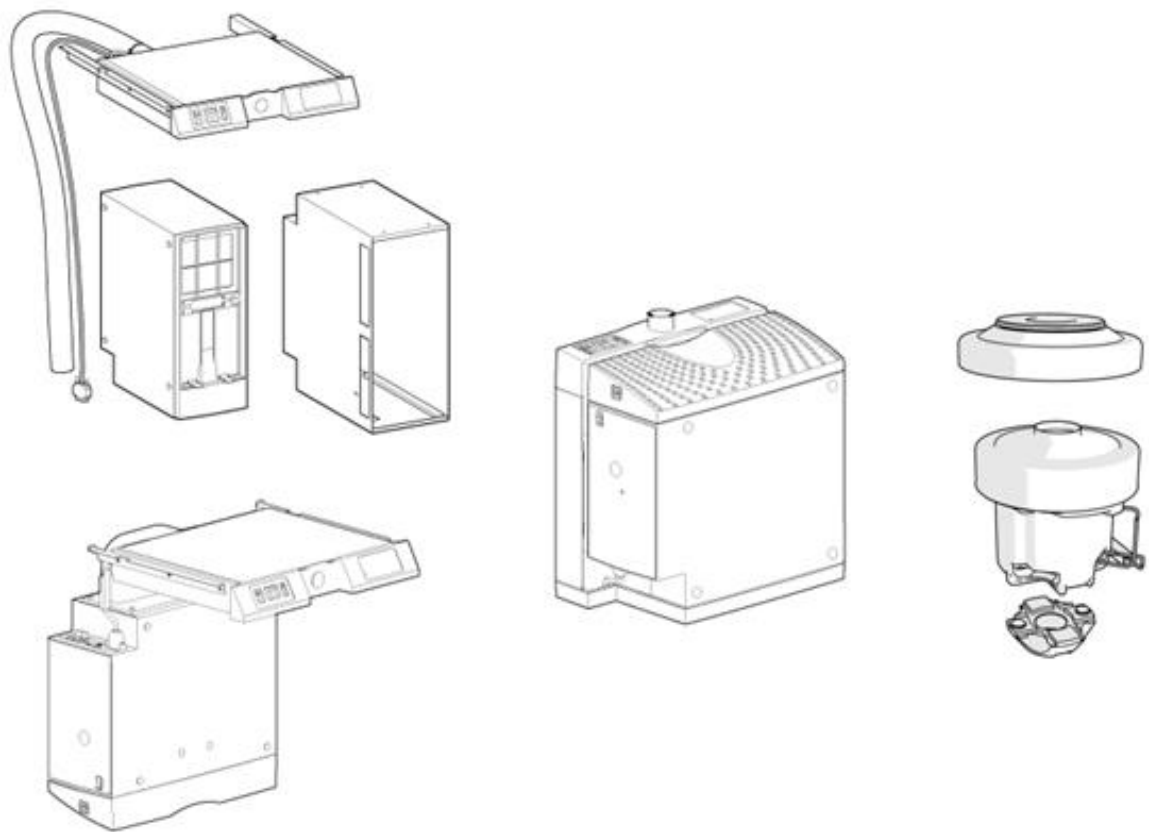

All the trademarks mentioned in these instructions for use are the property of their respective owners.

All the technical data, information and properties of the product described in these instructions for use were correct at the time of printing.

The product may be modified or improved as a result of technical developments.
This does not give entitlement to have already existing products upgraded.

Manufacturer: _____



Sycotec GmbH & Co. KG
Wangener Straße 78
88299 Leutkirch
GERMANY

Phone: +49 7561 86-0
Fax: +49 7561 86-266
Email: info@sycotec.eu
Website: www.sycotec.eu



Contents





1	User information	4
1.1	Target group of the document	4
1.2	Applied symbols	4
2	Safety	4
2.1	Warning signs	4
2.2	Safety instructions	4
3	Fan set 2.001.7298	5
4	Replacing fan	5
4.1	Removing the fan	6
4.2	Installing the fan	9
5	Commissioning	12

1 User information

1.1 Target group of the document

This dokument is for service technicians.

1.2 Applied symbols

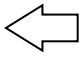
	Important information
	Manufacturer
	CE label
	Close, screw in, fasten, etc.
	Open, remove, loosen, etc.

2 Safety

2.1 Warning signs

Structure of warning signs

HAZARD SYMBOL Nature or source of hazard

Description of the nature or source of hazard and its possible consequences.

► Measures to avoid the hazard

Risk levels

WARNING Warning

Indicates a hazardous situation that could lead to serious or fatal injuries.

CAUTION Caution

Indicates a hazardous situation that could lead to minor or moderate injuries.

ATTENTION Attention

Indicates a hazardous situation that could lead to property damage.

2.2 Safety instructions

 These Assembly Instructions are only valid in conjunction with the corresponding operating instructions and in compliance with all safety instructions.

WARNING Electrical power

Death or injury from electric shock.

- Before servicing, pull the mains plug out of the socket or completely disconnect the device from the power to de-energise it.
- After conversion, the electrotechnical safety must be checked in accordance with IEC 62638 (VDE 0701 / 0702).

CAUTION Improper maintenance or repair of the unit

Damage to and malfunction of the unit

- Repair and servicing work on the electronic part of the unit may be done only by skilled staff or technicians.
- Use original spare parts only.

3 Fan set 2.001.7298

- SycoVac mono / SycoVac mono Type: plus
- SycoVac mono Type: mobile / SycoVac mono Type: mobile plus
- SMARTair FLEXspace / SMARTair Evo FLEXspace

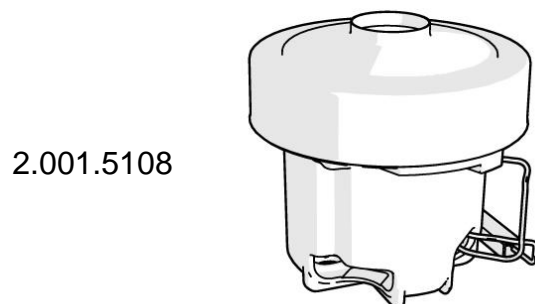
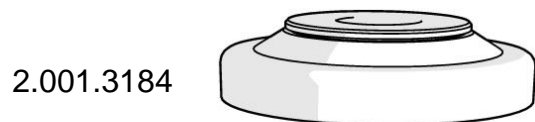

4 Replacing fan



Before installing a new fan unit, check whether the correct air baffle is present!

Correct!

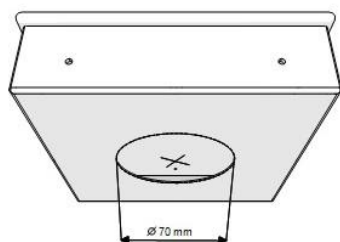

Ø 70 mm

Incorrect

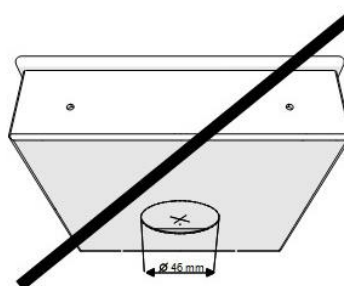

Ø 46 mm

4.1 Removing the fan

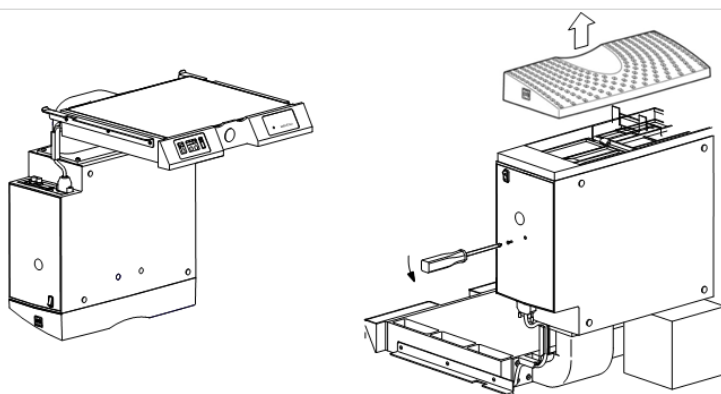

SycoVac mono / SycoVac mono Typ: plus

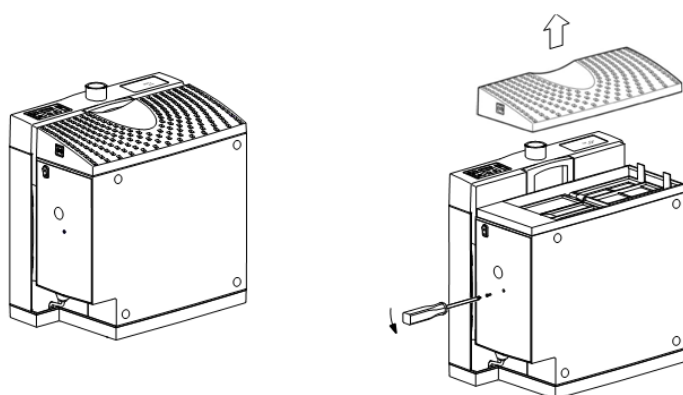

SycoVac mono Typ: mobile / SycoVac mono Typ: mobile plus

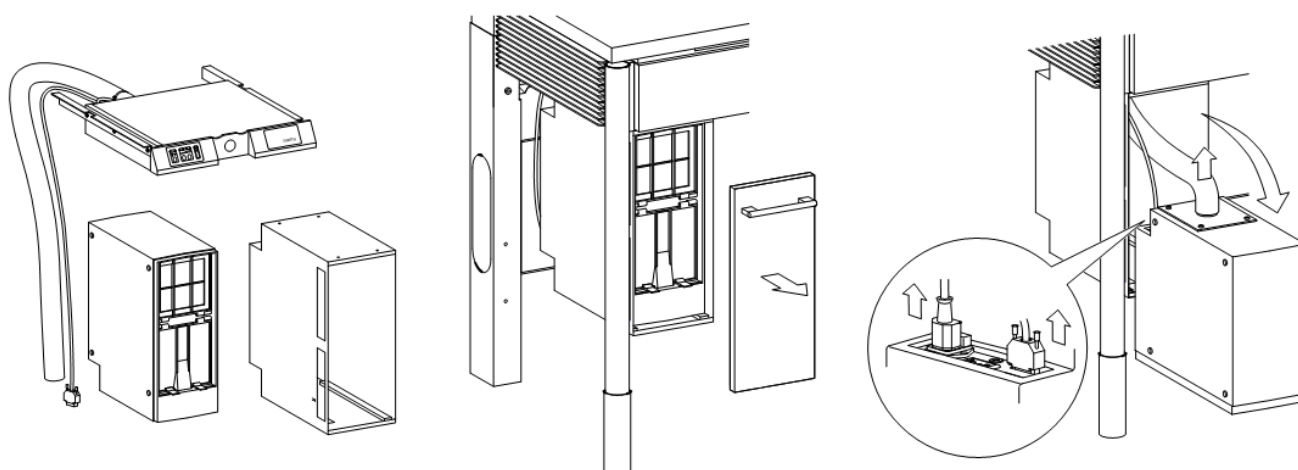

SMARTair FLEXspace / SMARTair Evo FLEXspace

⚠ WARNING Electrical power

Death or injury from electric shock.

- ▶ Before servicing, pull the mains plug out of the socket or completely disconnect the device from the power to de-energise it.
- ▶ After conversion, the electrotechnical safety must be checked in accordance with IEC 62638 (VDE 0701 / 0702).



Connector A is only present on SycoVac mono Type: plus.

4.1.1

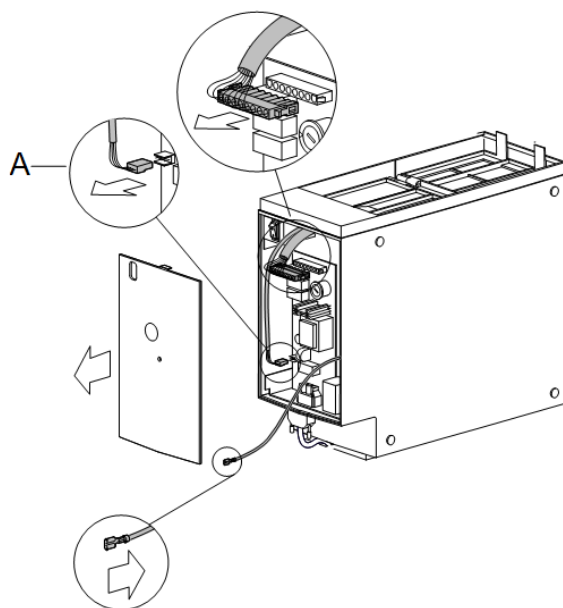

4.1.2

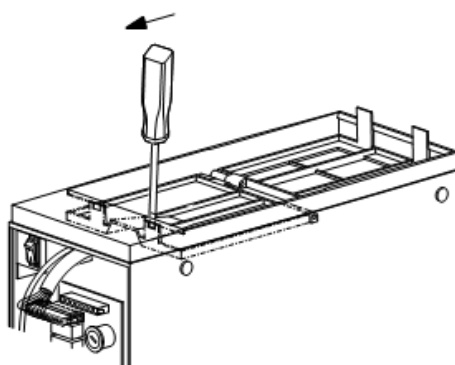

4.1.3

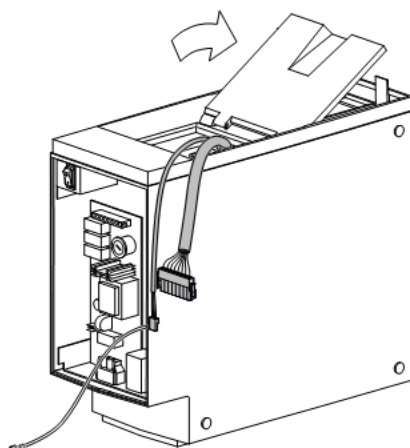

4.1.4

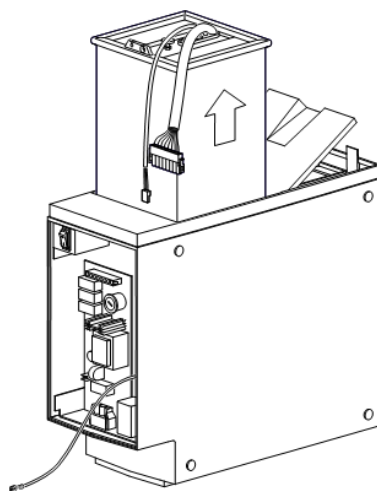

4.1.5

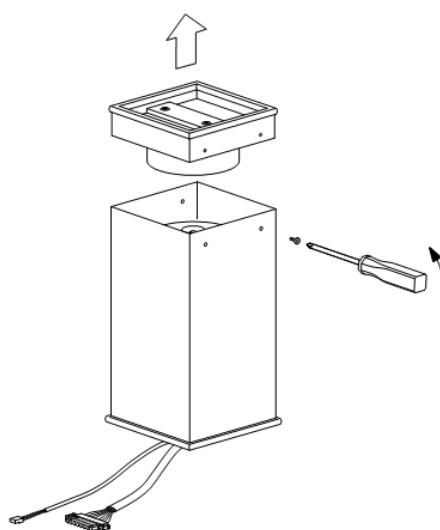

4.1.6

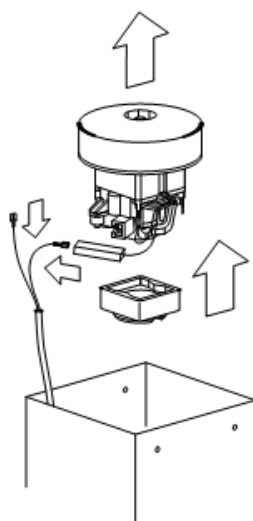

4.2 Installing the fan

4.2.1

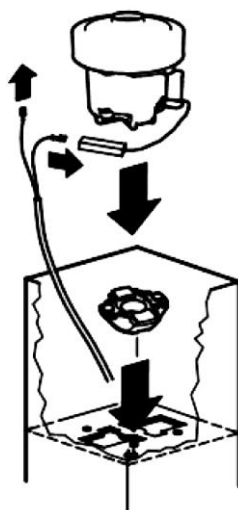

4.2.2

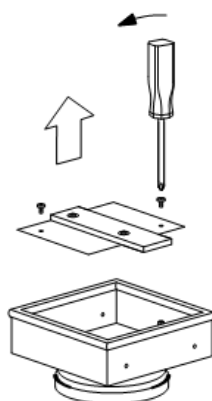

4.2.3

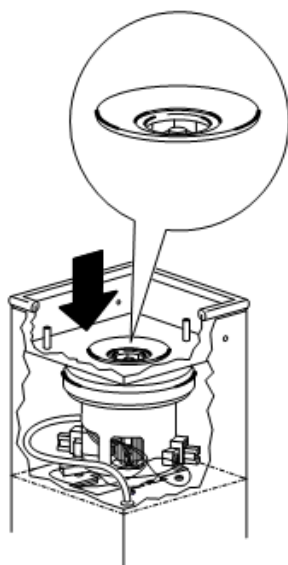

4.2.4

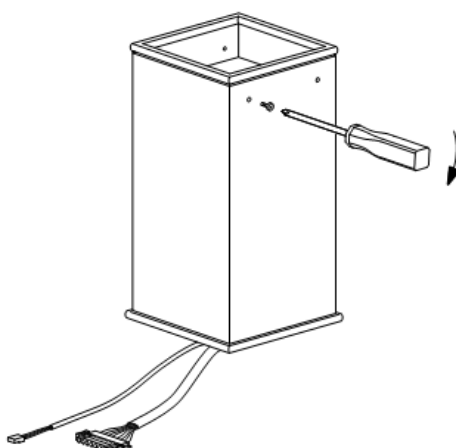

4.2.5

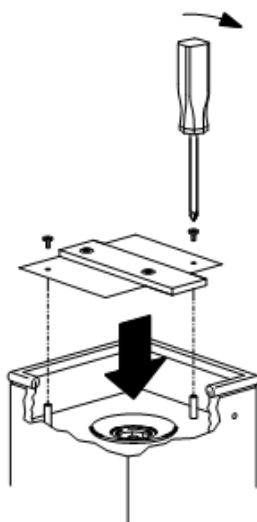

4.2.6

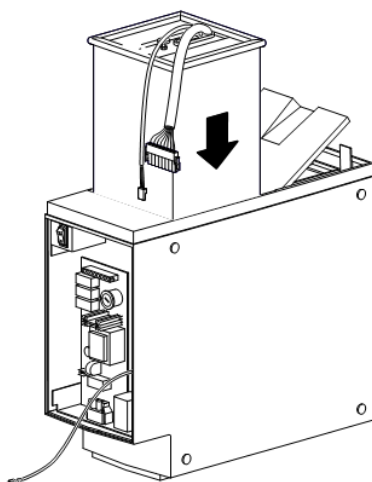

i Connector A is only present on SycoVac mono Type: plus.

4.2.7

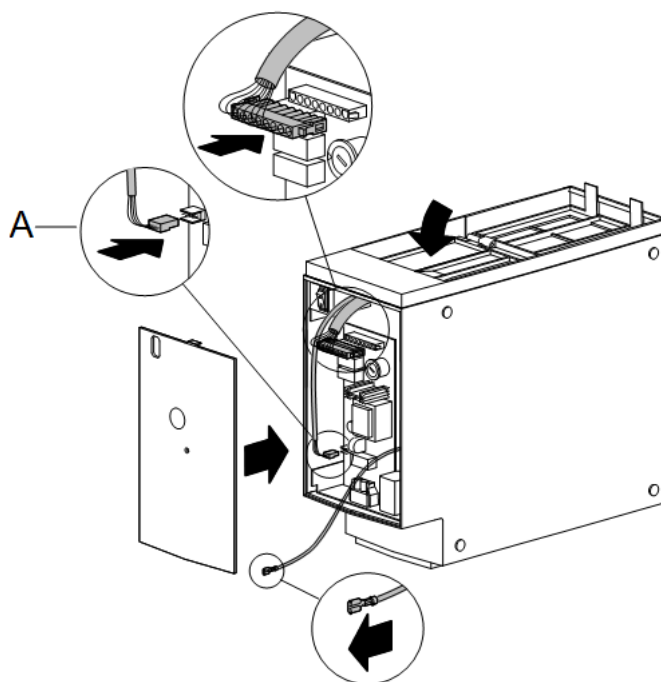

4.2.8

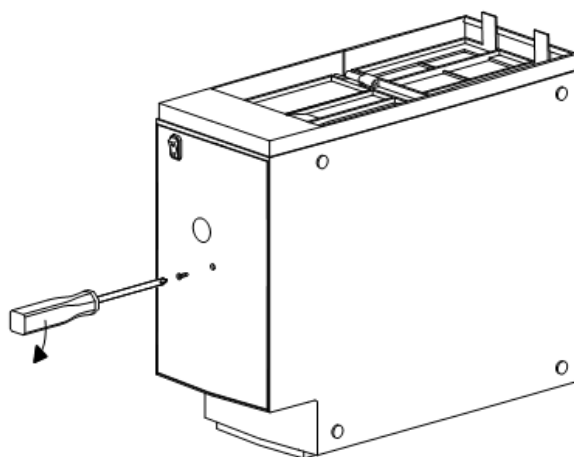

5 Commissioning

► Perform general functional tests.



Perform electrical safety checks according to IEC 62638 (VDE 0701 / 0702).



The safety check must be performed after the kit has been assembled.
See Instructions for Use.

ATTENTION

Refer to the respective Instructions for Use for information on operating the units.