

SycoTec Fan set 2.001.7300

Assembly Instructions

EN

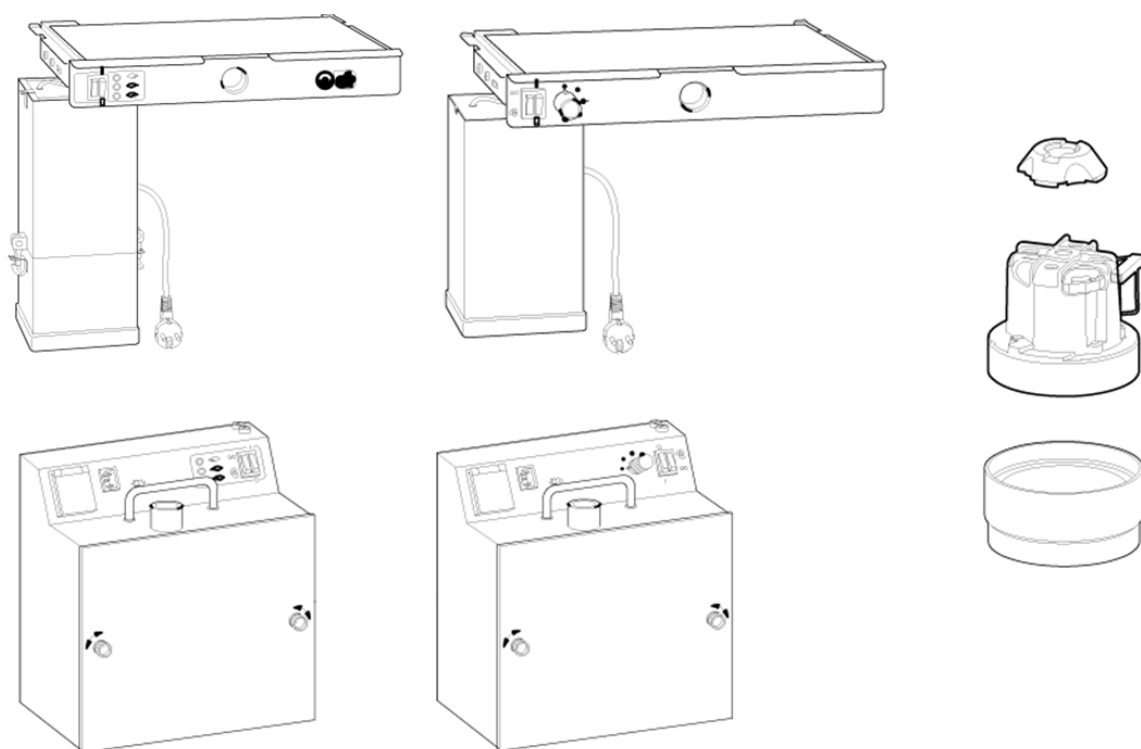

Contents

1	User information	3
1.1	Target group of the document	3
1.2	Applied symbols	3
2	Safety	3
2.1	Warning signs	3
2.2	Safety instructions	3
3	Fan set 2.001.7300	4
4	Replacing fan	4
4.1	Motor filter drawer Standard	5
4.2	Motor filter drawer Universal	9
4.3	Dust suction unit mobil Standard / Universal	15
5	Commissioning	22

All the trademarks mentioned in these instructions for use are the property of their respective owners.

All the technical data, information and properties of the product described in these instructions for use were correct at the time of printing.

The product may be modified or improved as a result of technical developments.
This does not give entitlement to have already existing products upgraded.

Manufacturer: _____



Sycotec GmbH & Co. KG
Wangener Straße 78
88299 Leutkirch
GERMANY

Phone: +49 7561 86-0
Email: info@sycotec.eu
Website: www.sycotec.eu







1 User information

1.1 Target group of the document

This dokument is for service technicians.

1.2 Applied symbols

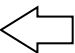
	Important information
	Manufacturer
	CE label
	Close, screw in, fasten, etc.
	Open, remove, loosen, etc.

2 Safety

2.1 Warning signs

Structure of warning signs

HAZARD SYMBOL Nature or source of hazard

Description of the nature or source of hazard and its possible consequences.

► Measures to avoid the hazard

Risk levels

WARNING Warning

Indicates a hazardous situation that could lead to serious or fatal injuries.

CAUTION Caution

Indicates a hazardous situation that could lead to minor or moderate injuries.

ATTENTION Attention

Indicates a hazardous situation that could lead to property damage.

2.2 Safety instructions

 These Assembly Instructions are only valid in conjunction with the corresponding operating instructions and in compliance with all safety instructions.

WARNING Electrical power

Death or injury from electric shock.

- Before servicing, pull the mains plug out of the socket or completely disconnect the device from the power to de-energise it.
- After conversion, the electrotechnical safety must be checked in accordance with IEC 62638 (VDE 0701 / 0702).

CAUTION Improper maintenance or repair of the unit

Damage to and malfunction of the unit

- Repair and servicing work on the electronic part of the unit may be done only by skilled staff or technicians.
- Use original spare parts only.

3 Fan set 2.001.7300

- Motor filter drawer Standard, H55, G55
- Motor filter drawer Universal, H50, G50
- Dust suction unit mobil Standard
- Dust suction unit mobil Universal

2.001.3185



2.001.7775



4 Replacing fan



Before installing a new fan unit, check whether the correct transformer (1.000.4656) is available. Ensure that the correct size is used and reorder if necessary.

Correct!

Transformer 1.000.4656

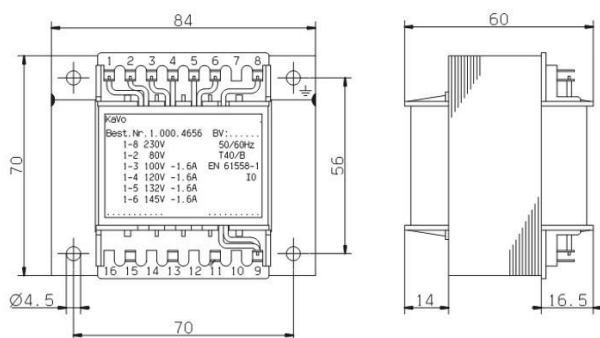

Incorrect

Transformer 0.642.0191

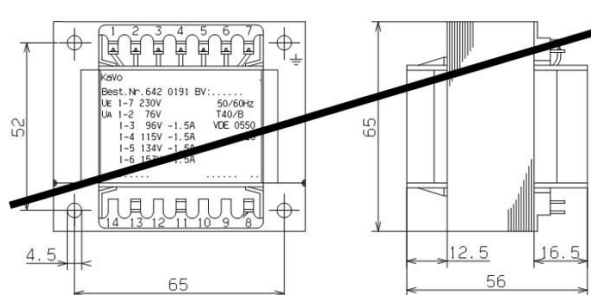

4.1 Motor filter drawer Standard

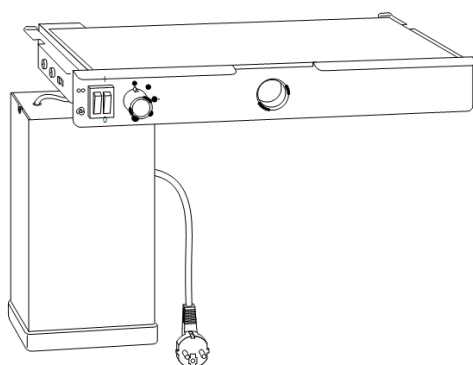

⚠ WARNING Electrical power

Death or injury from electric shock.

- ▶ Before servicing, pull the mains plug out of the socket or completely disconnect the device from the power to de-energise it.
- ▶ After conversion, the electrotechnical safety must be checked in accordance with IEC 62638 (VDE 0701 / 0702).

4.1.1

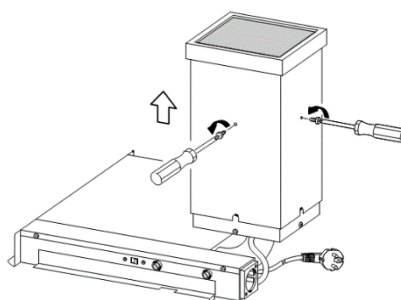

4.1.2



4.1.3

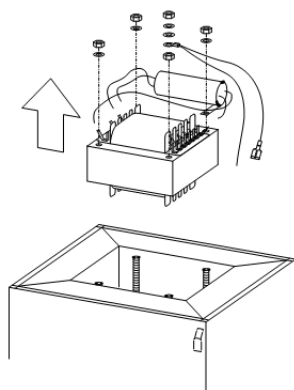

4.1.4

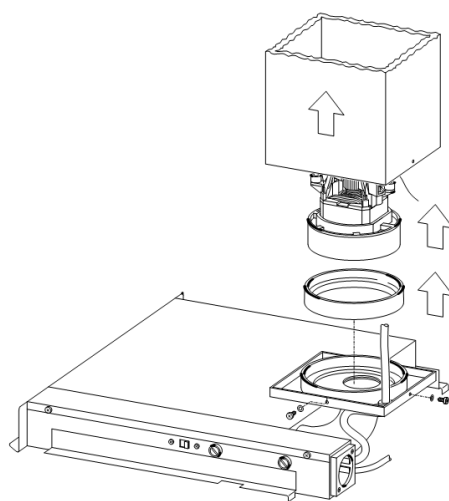

4.1.5

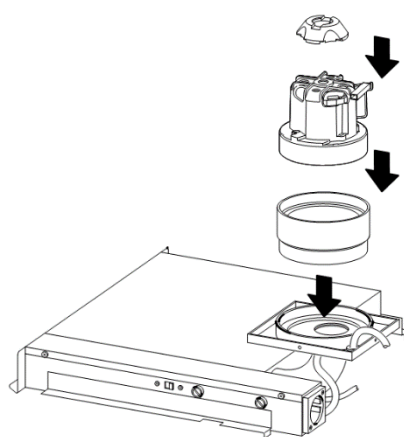

4.1.6

6

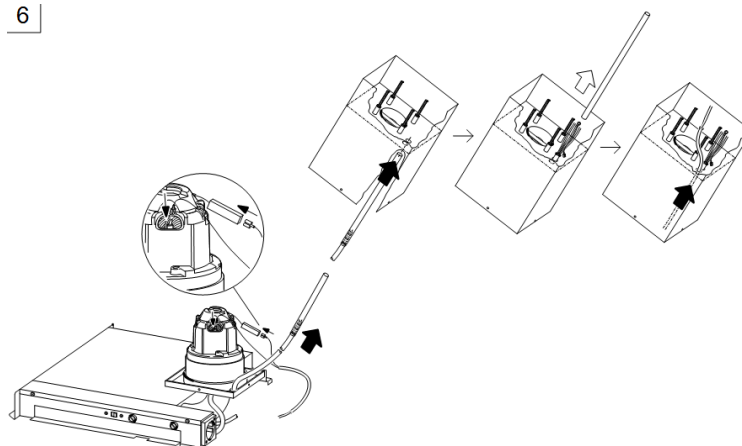

4.1.7

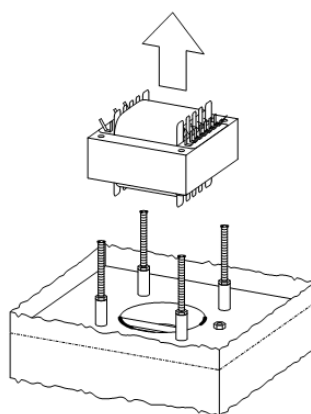

4.1.8

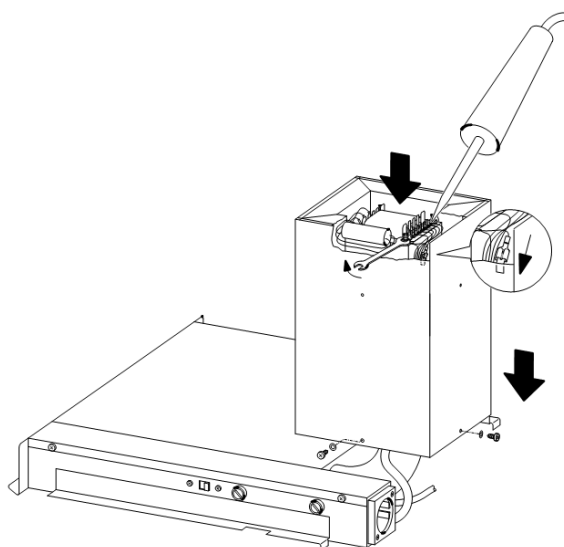

Circuit board – Motor filter drawer Standard

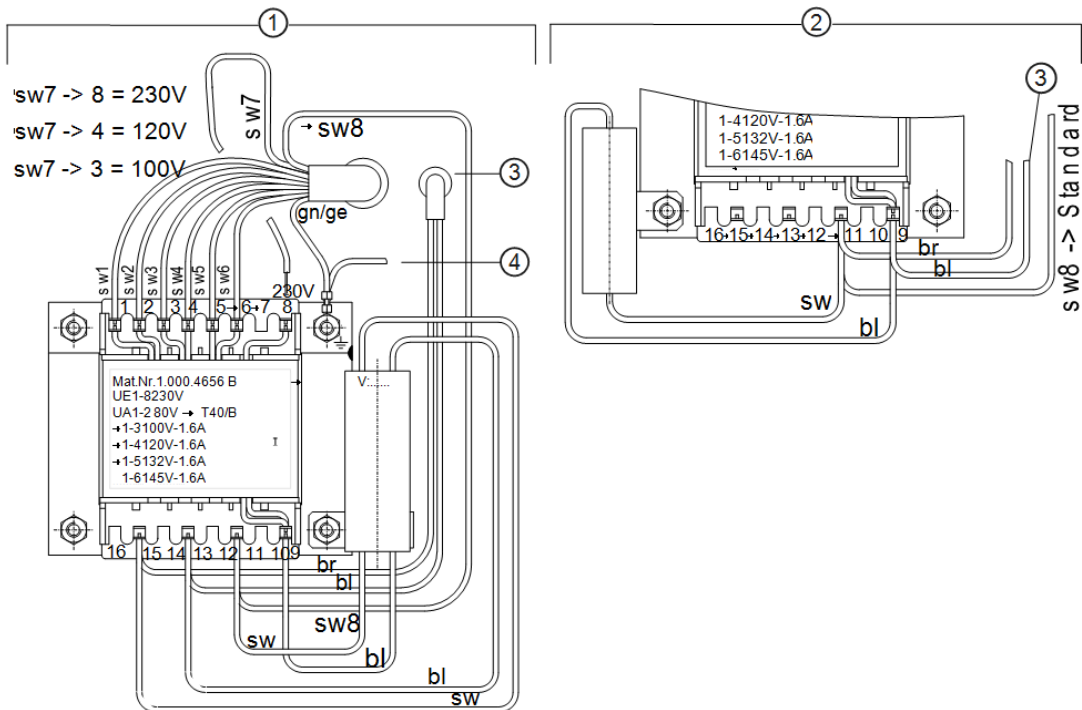

- | | |
|---|---|
| (1) Design with new interference suppression filter | (2) Design with old interference suppression filter |
| (3) Cable to fan motor | (3) Cable to fan motor |
| (4) Cable to the housing | |

Color chart

sw	black
bl	blue
br	brown
ge	yellow
gr	grey

4.1.9

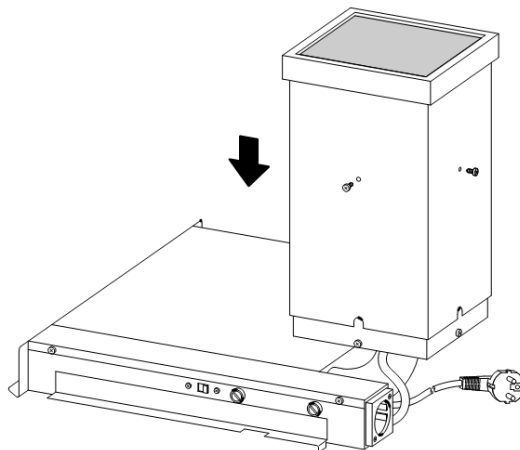

Perform electrical safety checks according to IEC 62638 (VDE 0701 / 0702).

4.2 Motor filter drawer Universal

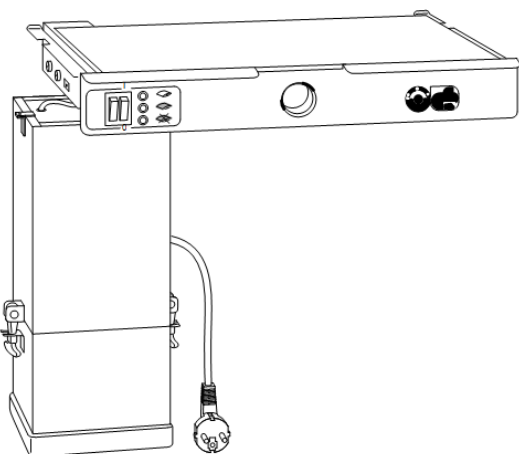

⚠ WARNING Electrical power

Death or injury from electric shock.

- ▶ Before servicing, pull the mains plug out of the socket or completely disconnect the device from the power to de-energise it.
- ▶ After conversion, the electrotechnical safety must be checked in accordance with IEC 62638 (VDE 0701 / 0702).

4.2.1

- ▶ Cut off silicone sealant with a knife

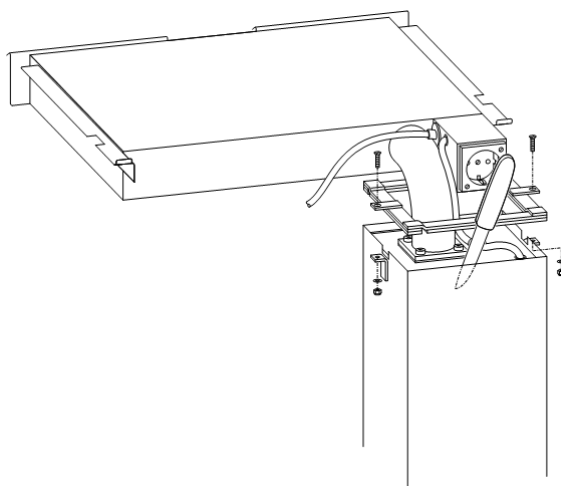

4.2.2

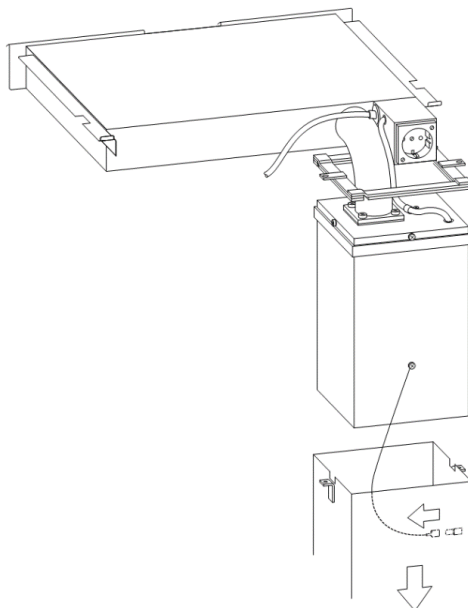

4.2.3

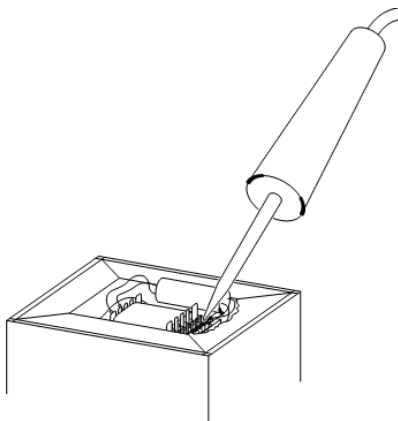

4.2.4

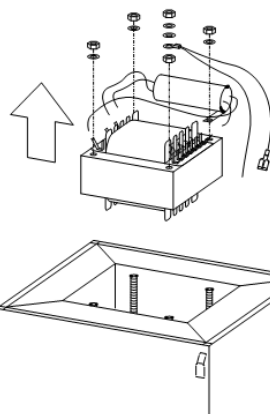

4.2.5

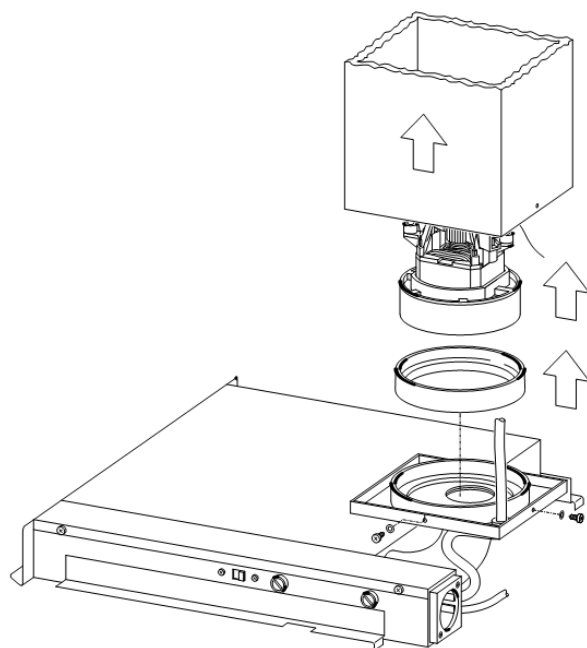

4.2.6

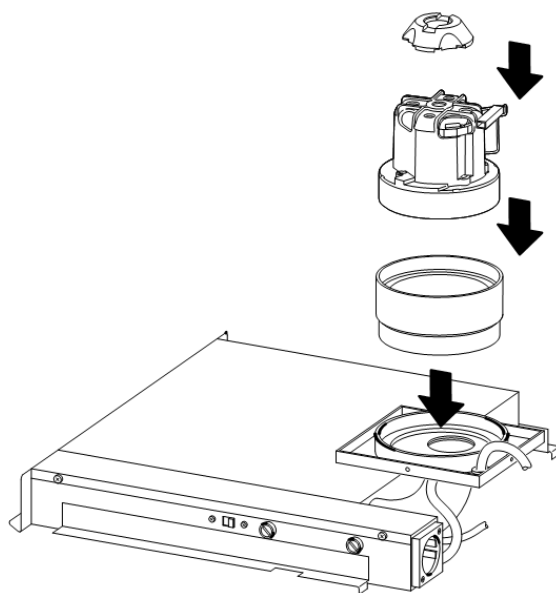

4.2.7

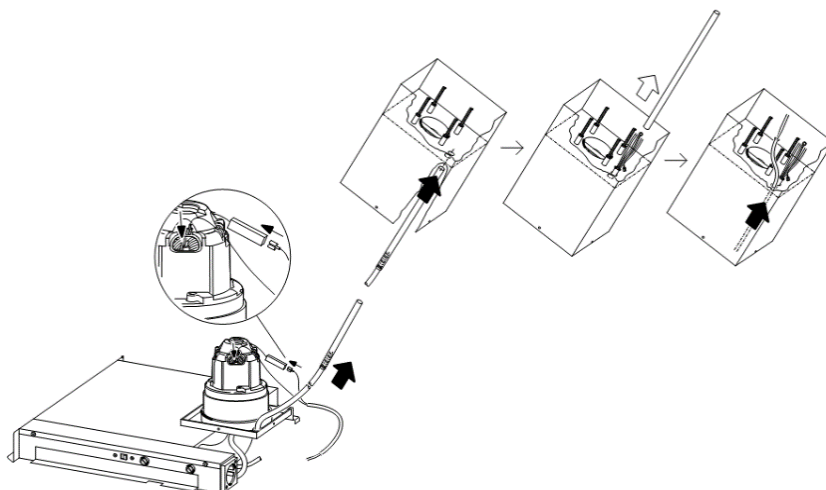

4.2.8

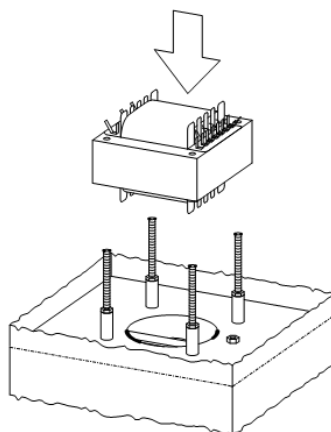

4.2.9

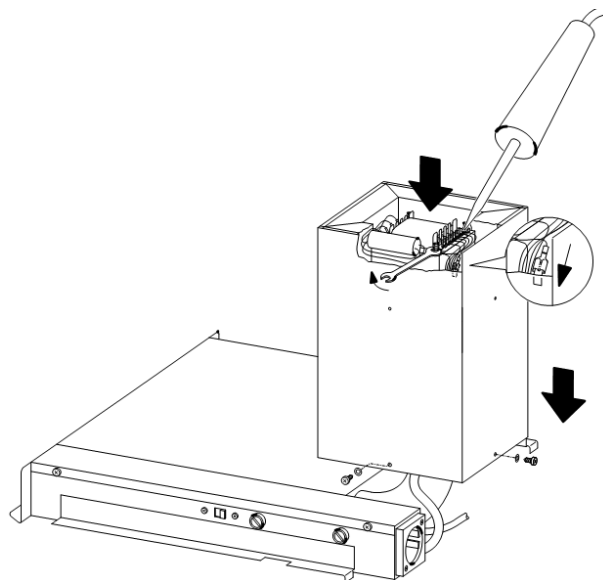

Circuit board – Motor filter drawer Universal

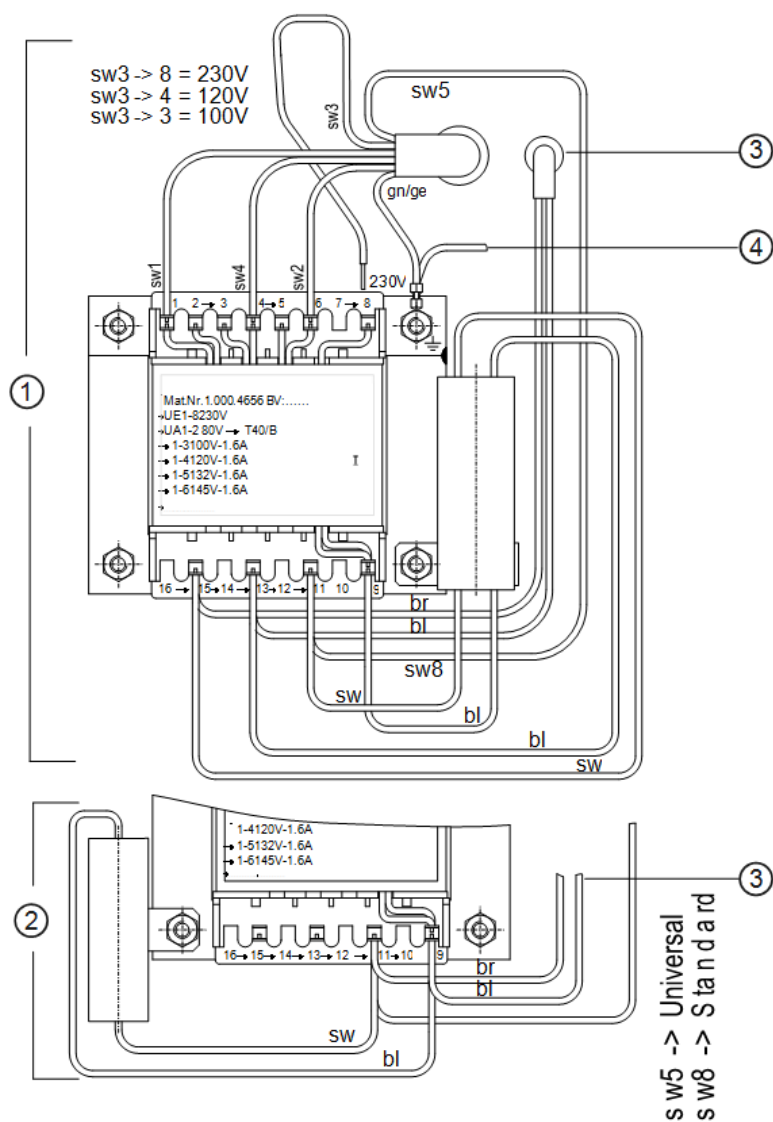

- | | |
|---|--------------------------|
| (1) Design with new interference suppression filter | (3) Cable to fan motor |
| | (4) Cable to the housing |
| (2) Design with old interference suppression filter | (3) Cable to fan motor |

Color chart

sw	black
bl	blue
br	brown
ge	yellow
gr	grey

4.2.10

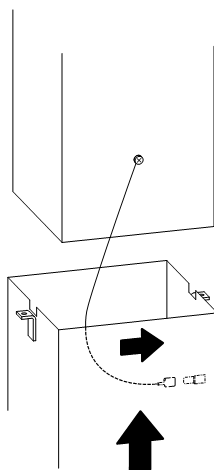

4.2.11 ► Grouting with silicone sealant.

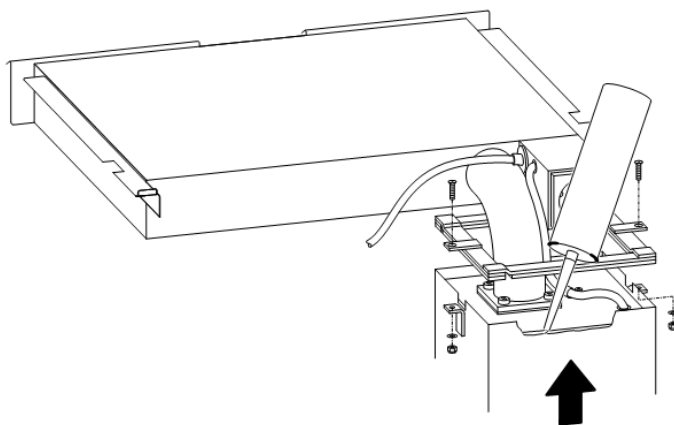

Perform electrical safety checks according to IEC 62638 (VDE 0701 / 0702).

4.3 Dust suction unit mobil Standard / Universal

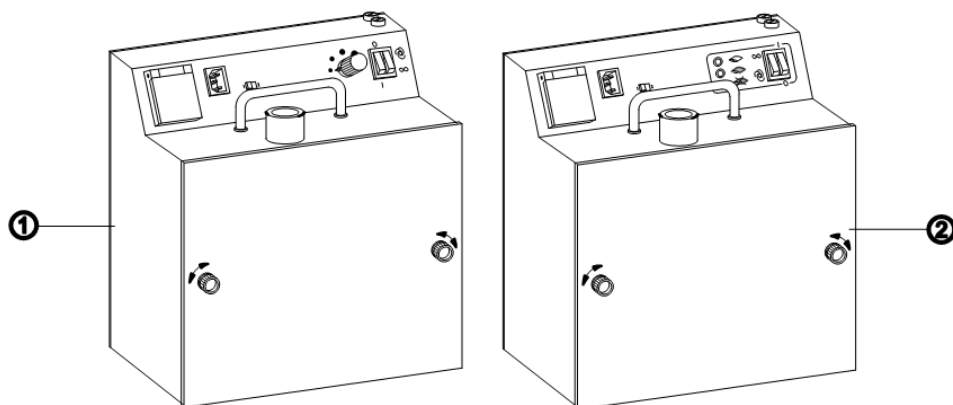

(1) Dust suction unit mobil Standard

(2) Dust suction unit mobil Universal

i The fan replacement for dust suction unit mobil Standard and dust suction unit mobil Universal is identical.

⚠ WARNING Electrical power

Death or injury from electric shock.

- ▶ Before servicing, pull the mains plug out of the socket or completely disconnect the device from the power to de-energise it.
- ▶ After conversion, the electrotechnical safety must be checked in accordance with IEC 62638 (VDE 0701 / 0702).

4.3.1

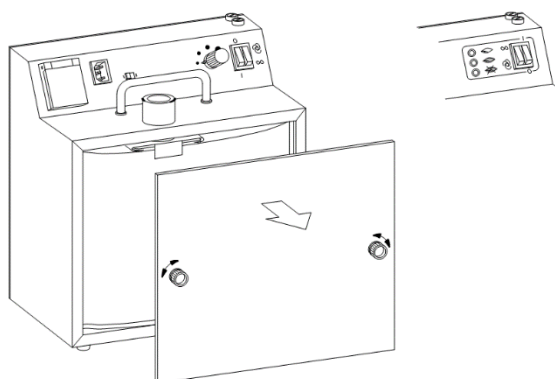

4.3.2

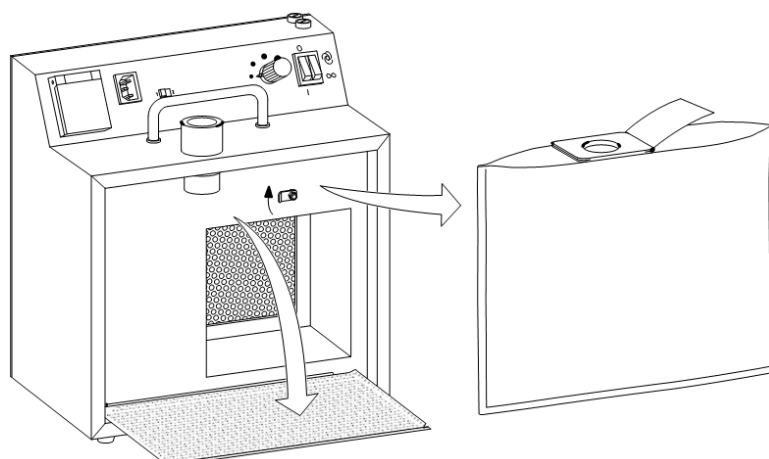

4.3.3

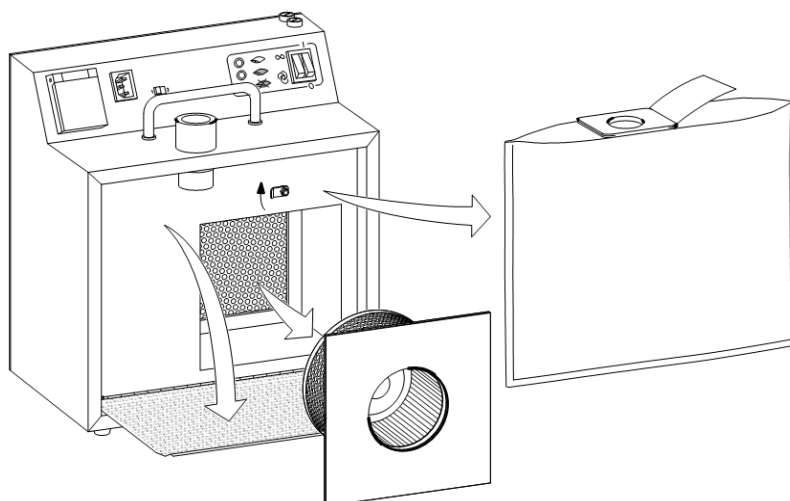

4.3.4

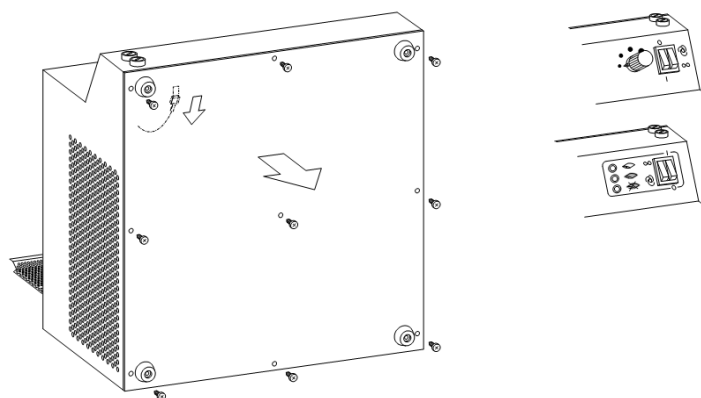

4.3.5

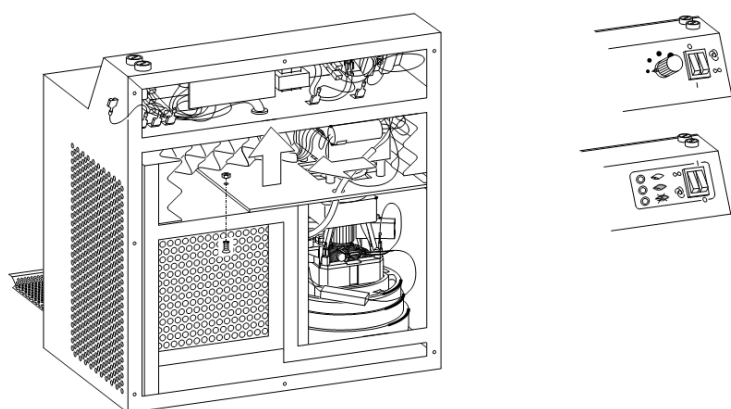

4.3.6

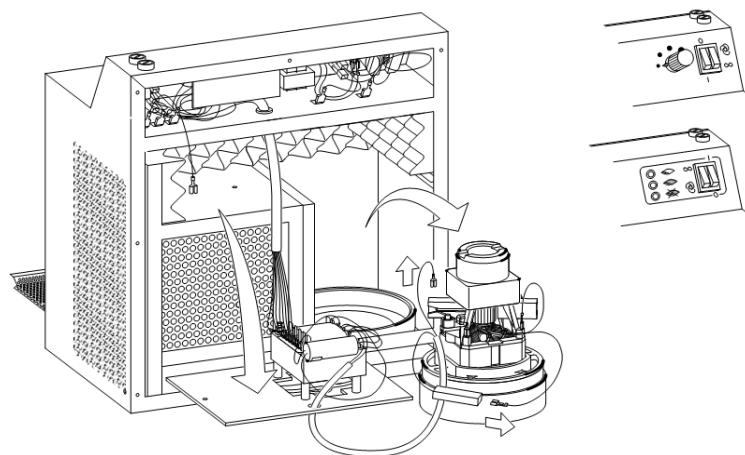

4.3.7

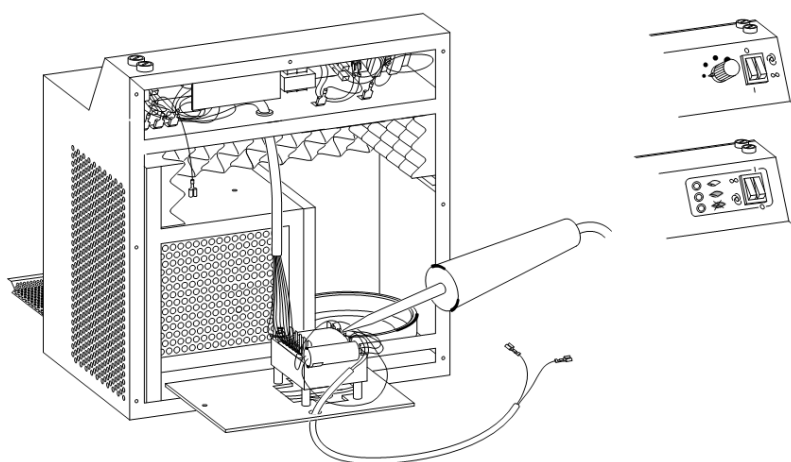

Circuit board – Dust suction unit mobil Standard

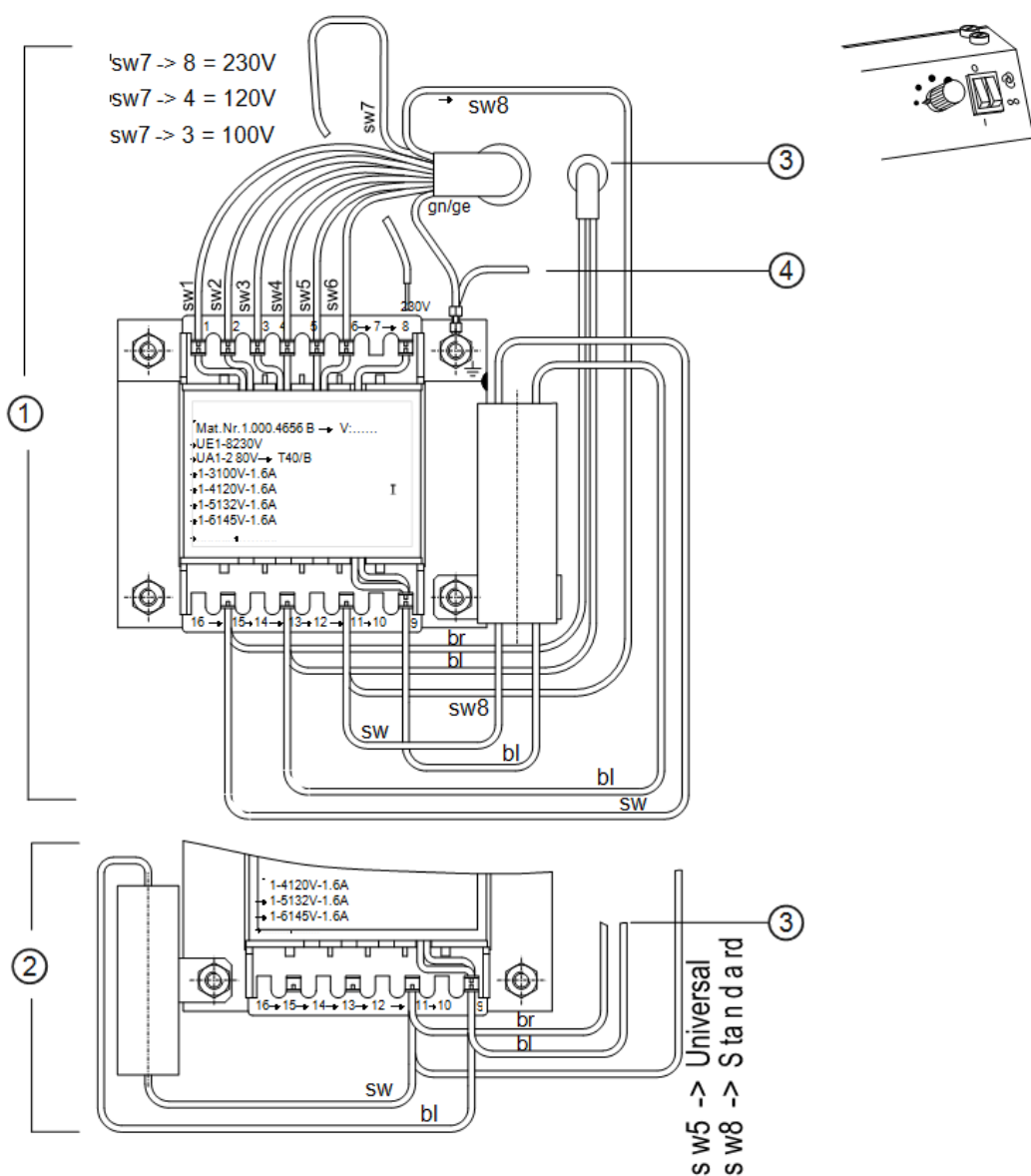

- | | |
|---|--------------------------|
| (1) Design with new interference suppression filter | (3) Cable to fan motor |
| | (4) Cable to the housing |
| (2) Design with old interference suppression filter | (3) Cable to fan motor |

Color chart

sw	black
bl	blue
br	brown
ge	yellow
gr	grey

Circuit board – Dust suction unit mobil Universal

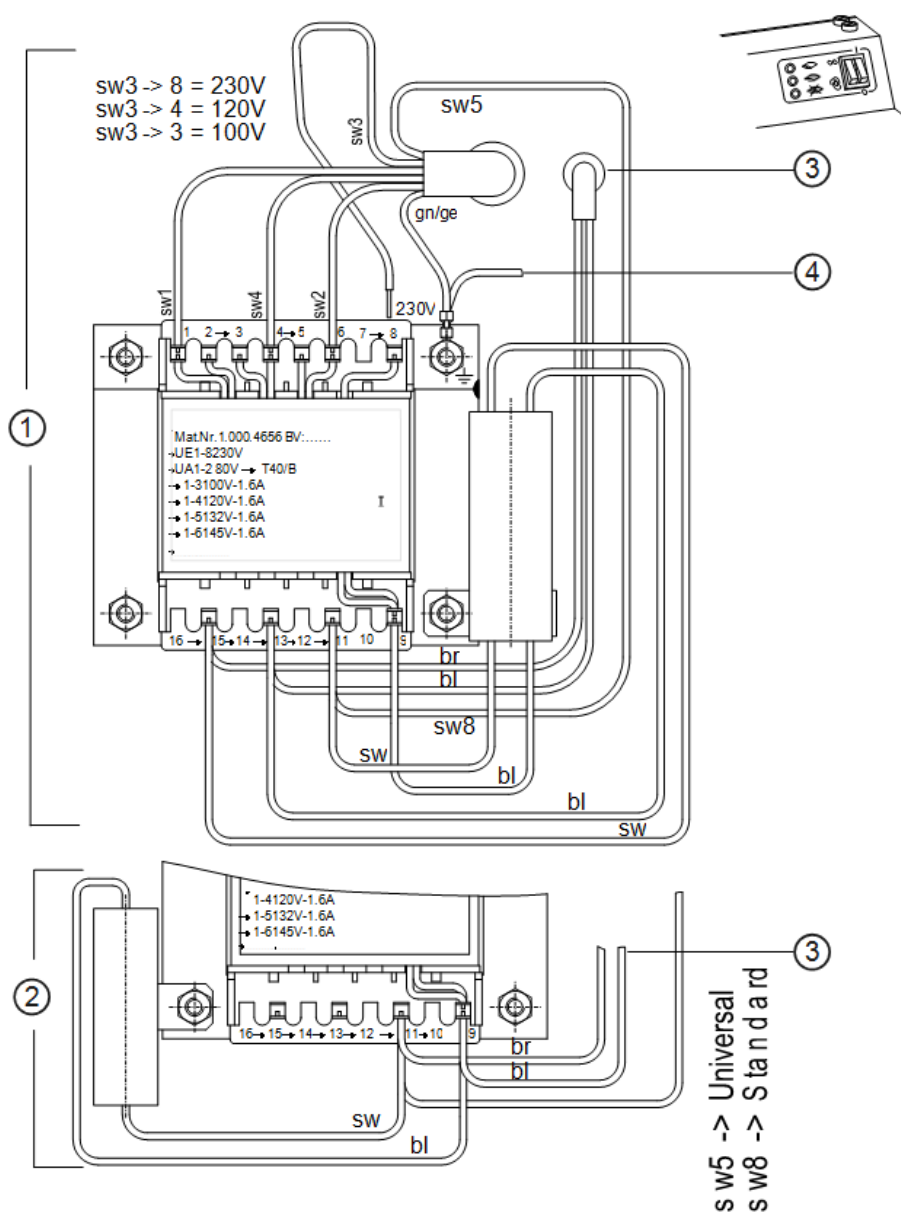

- | | |
|---|--------------------------|
| (1) Design with new interference suppression filter | (3) Cable to fan motor |
| | (4) Cable to the housing |
| (2) Design with old interference suppression filter | (3) Cable to fan motor |

Color chart

sw	black
bl	blue
br	brown
ge	yellow
gr	grey

4.3.8



4.3.9

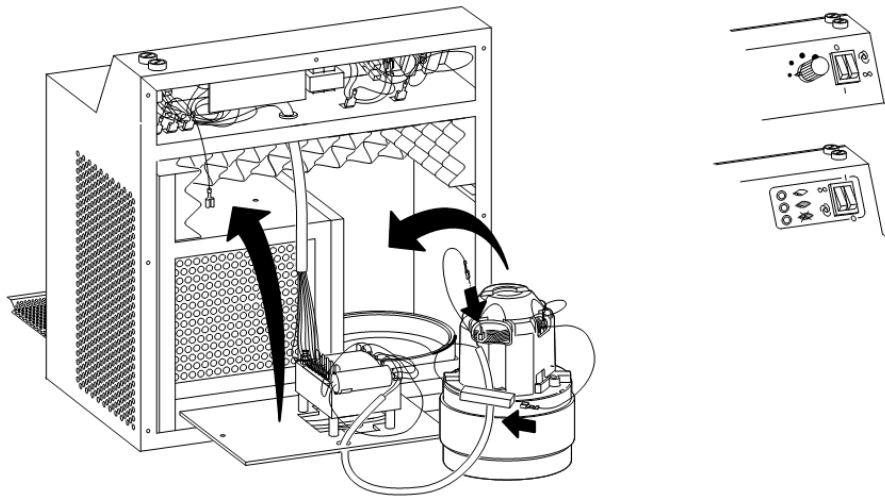

4.3.10

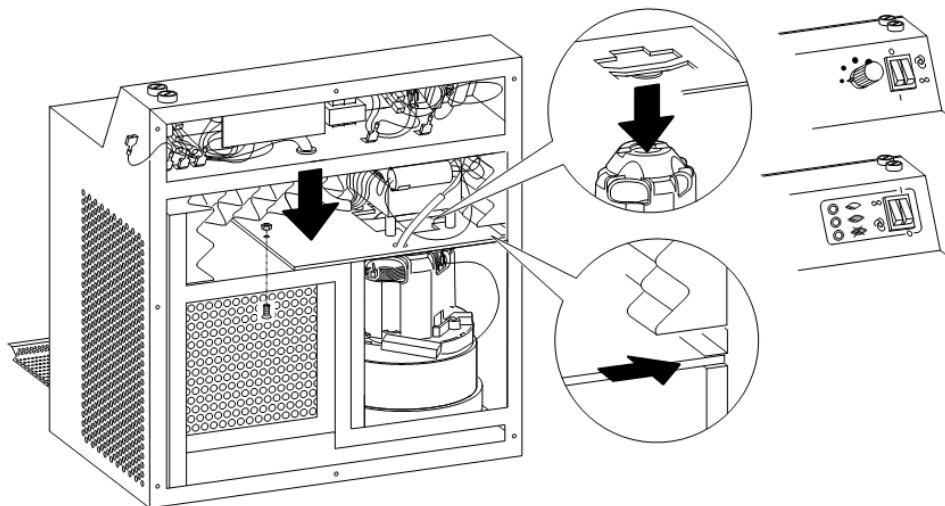

4.3.11

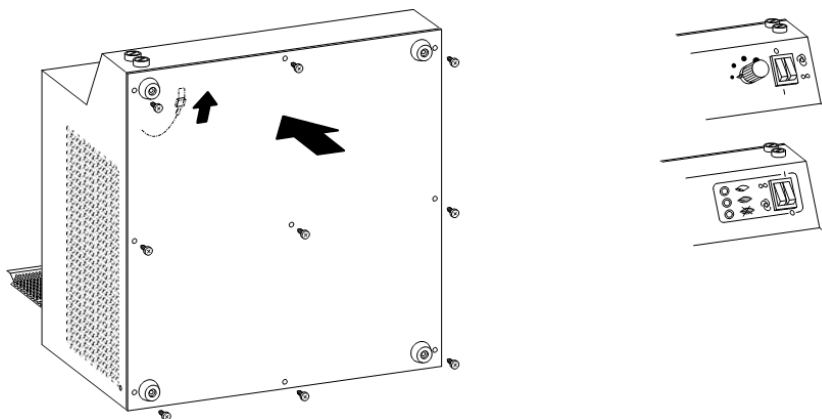

4.3.12

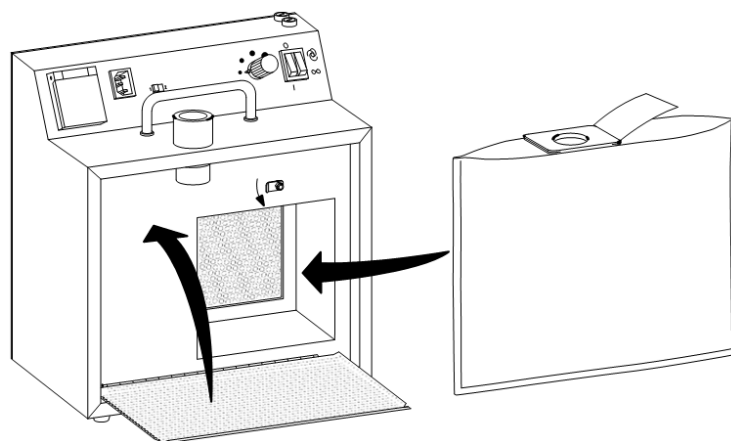

4.3.13

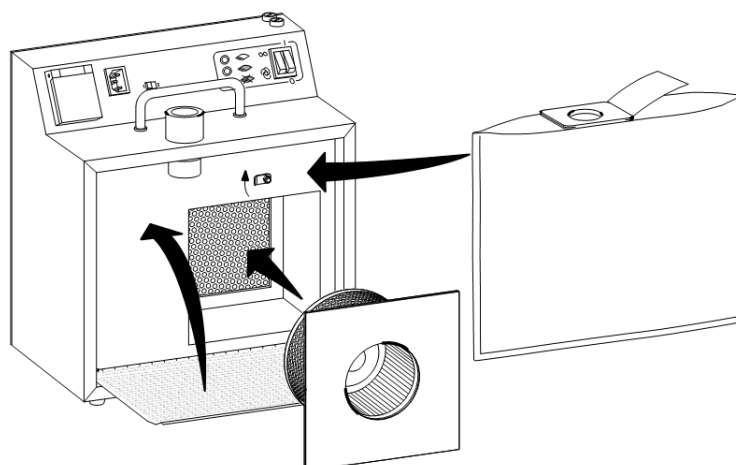

4.3.14

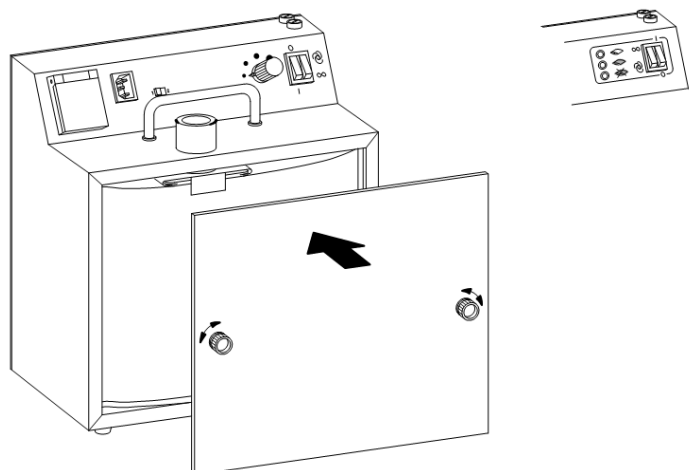

5 Commissioning

► Perform general functional tests.

i Perform electrical safety checks according to IEC 62638 (VDE 0701 / 0702).

i The safety check must be performed after the kit has been assembled.
See Instructions for Use.

ATTENTION

Refer to the respective Instructions for Use for information on operating the units.